	<b>Name of Activity: End of Day Cleaning and Disinfecting Reusable Respirators (elastomeric full and half face respirators)</b>  <b>Role performing Activity:</b>		
<h1 style="text-align: center;">WORK STANDARD</h1>	<b>Location: SHA</b>		
	<b>Document Owner:</b> Jeff Schwan/SASWH	<b>Region/Organization where this Work Standard originated: SASWH</b>	
	<b>Date Prepared:</b> May 7, 2020	<b>Last Revision:</b>	<b>Date Approved:</b>

**Work Standard Summary:** It would be the responsibility of the worker assigned to wear the respirator to conduct the step by step end of day cleaning and disinfection of the respirator

### Essential Tasks:

**To ensure proper cleaning and disinfecting/sanitizing of reusable elastomeric respirators.**

Room should be set up for cleaning/sanitizing of respirators with three (3) wash tubs with instructions attached for each tub:

- one for washing with a mild soap and warm water; and
- second can be an approved disinfectant solution or an approved wipe; and
- third tub would be a rinse with warm water

Current CSA Standard indicates running water is preferable and ensure rinsing re residue challenges. On either end of the tubs there must be pads to put your respirator on when dismantling, and one pad on the other side of the rinse once parts have been cleaned.



**Please refer to disinfectant/sanitizer for proper mix ratios and contact time.**

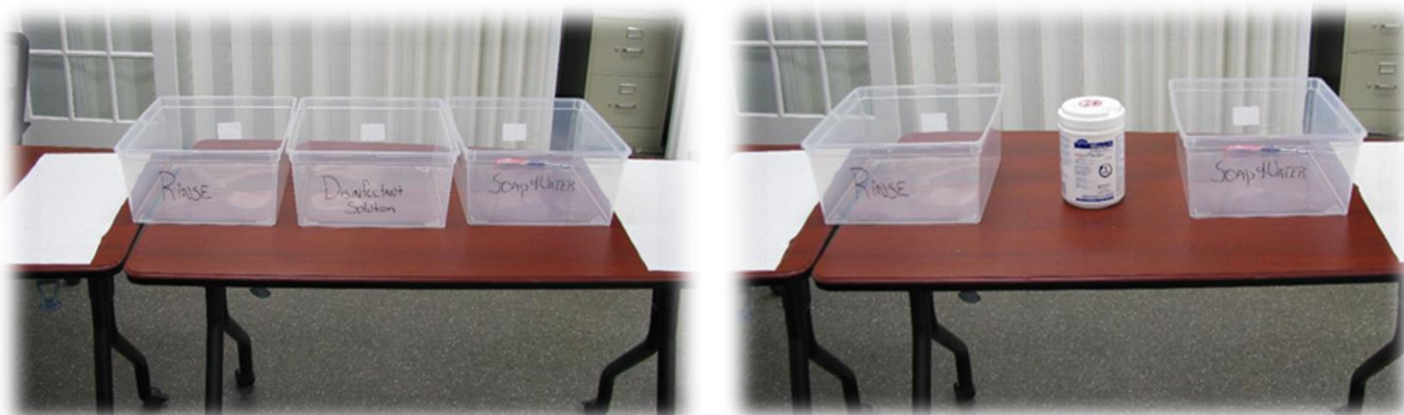

**Detergents that dry on face pieces (during air dry) may result in adverse skin reactions; some disinfectants can cause deterioration of rubber or corrosion of metal parts if not completely removed (see CSA Standard Annex F).**

**Please ensure that a SDS is readily available for the disinfectant at the cleaning station.**

Examples of tub set up:



1	Doff respirator as per SHA guidelines in area identified to conduct cleaning/disinfecting.
	
2	Once respirator is doffed, appropriately doff and dispose of gloves then wash or sanitize hands. Donn a new pair of gloves, then remove cartridges from the respirator. Place cartridges on pad beside the soap and water tub. This will be your potentially contaminated pad.
	
3	Remove strap from face piece and place in water soap tub.
4	Remove inhalation valves and valve bodies if possible, and exhalation valves and valve bodies if possible. During this step check to make sure the valves are in good condition with no cracks or warping. If damaged, replace with new ones and discard old valves appropriately. If valves pass visual inspection place the valves in the soap water tub.
5	Place the face piece in the soap water tub.

6	Lightly scrub the strap use a stiff bristle [not wire] brush in the soapy water. Once washed, then place strap in the disinfectant tub or wipe down with an approved disinfectant wipe. Refer to product sheet and mix ratio to ensure parts have been submerged (or wipe has reached) for appropriate contact time. Once completed if using disinfectant wipe appropriately discard the wipe and then rinse thoroughly in rinse tub or under warm tap water and place on clean pad that is placed beside the rise tub.
	
7	Wash outside of cartridges with disinfectant solution or disinfectant wipe. DO NOT SUBMERSE the cartridge in the solution; place on clean pad. If using disinfectant wipe appropriately discard wipe after use. Refer to product sheet and mix ratio to ensure parts have been submerged or wiped have reached to appropriate contact time Please refer to attached list of Health Canada's approved disinfectants. <a href="https://www.canada.ca/en/health-canada/services/drugs-health-products/disinfectants/covid-19/list.html">https://www.canada.ca/en/health-canada/services/drugs-health-products/disinfectants/covid-19/list.html</a>
8	Gently scrub inhalation valves and exhalation valves and gaskets in soapy water then place in disinfectant solution or use disinfectant wipe. One wipe can be utilized for all valves. Discard wipe in appropriate container/garbage. Refer to product sheet and mix ratio to ensure parts have been submerged or wiped have reached to appropriate contact time.
9	Gently scrub valve bodies and place in disinfectant solution or wipe with disinfectant wipe. Appropriately discard wipe after use. Refer to product sheet and mix ratio to ensure parts have been submerged or wiped have reached to appropriate contact time.
10	Rinse valve bodies and place on clean pad with other clean parts.
11	Gently scrub face piece and or full face and conduct visual inspection at this time ensuring there is no rips or tears in the face piece.
12	Place face piece and or full face in disinfectant solution or use approved wipe. If cleaning full face this step will be repeated for the face piece and the lens body. Discard wipe in appropriate container/garbage. Refer to product sheet and mix ratio to ensure parts have been submerged or wiped have reached to appropriate contact time.
13	Rinse face piece in rinse water and place on clean pad with other clean parts.
	

14	Safely and appropriately dispose of soap water, disinfectant and rinse water. Discard pads in appropriate garbage/container; appropriately remove gloves and sanitize hands.
15	Drying of equipment/respirator can occur by wiping dry with clean towel or air dry.
16	Once dry, reassemble respirator and place in appropriate sealed container. Cartridges must be stored separately in a sealed container. Please ensure that you label the container with the date of cleaning and disinfection.

## List of Parts:

Please note: depending on manufactures make and model, and cartridge/filter, parts may look different. Please refer to manufactures instruction package that came with your respirator for parts listings.

The pictures below are 3M products.

## Half face

<https://multimedia.3m.com/mws/media/1478130/3m-half-facepiece-respirator-7500-series-user-instructions.pdf>

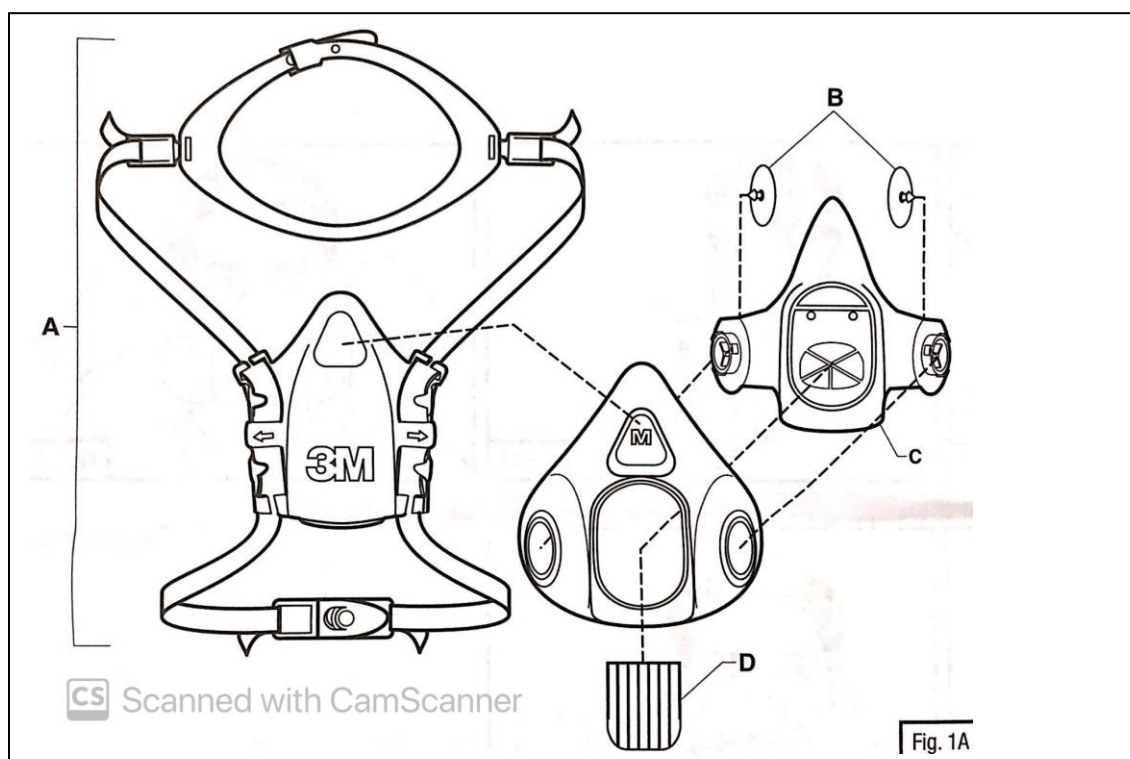

3M™ Half Facepiece 7500 Series		
Number	****AAD	Description
7501	37081	Small
7502	37082	Medium
7503	37083	Large
**** AAD part numbers are catalog numbers only. NIOSH approved as PSD part numbers		
Replacement Parts (Fig. 1A)		
Number	****AAD	Description
A	7581	Head Harness Assembly
B	7582	Inhalation Valves
C	7586	Cartridge/Filter Holder
D	7583	Exhalation Valve



Full Face

<https://multimedia.3m.com/mws/media/959950/3m-6000-series-full-facepiece-respirator-user-instructions.pdf>

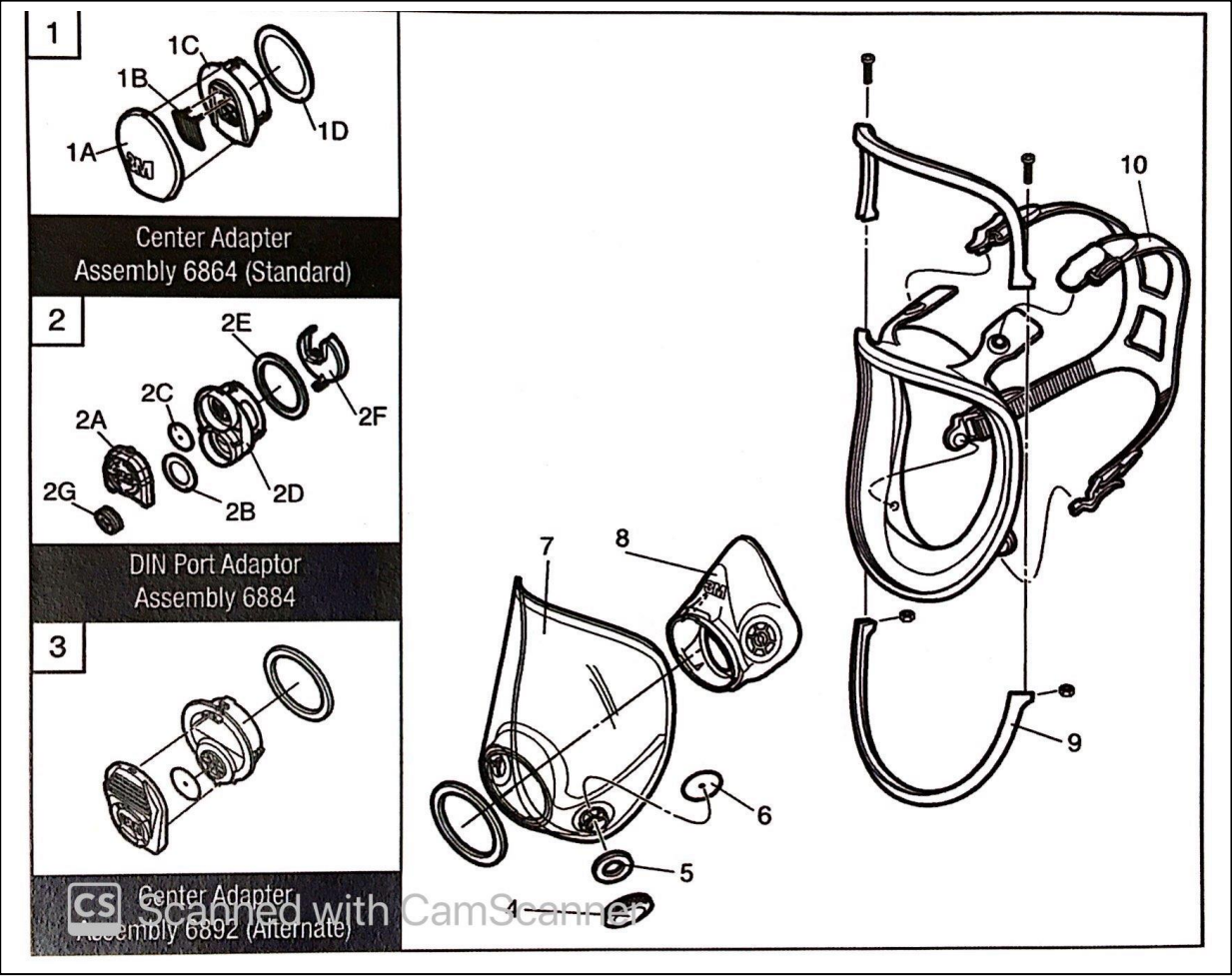

LIST OF PRODUCTS			
3M™ Full Facepiece 6000 Series Replacement Parts and Accessories			
Full Facepiece with 3M™ Center Adapter Assembly 6864			
Number	****AAD	Description	
6700	07138	Small	
6800	07139	Medium	
6900	07140	Large	
**** AAD part numbers are catalog numbers only. NIOSH approved as PSD part numbers			
Fig.	Number	****AAD	Description
1	6864		Center Adapter Assembly (Standard)
1A			Center Adapter Cover*
1B	7583		Exhalation Valve
1C			Center Adapter Base*
1D	6896		Center Adapter Gasket
2	6884		DIN Port Adapter Assembly
2A	6882		DIN Cover
2B	3876		Breathing Tube Gasket
2C	6889		Exhalation Valve
2D	6883		DIN Port Base
2E	6896		Center Adapter Gasket
2F	6881		DIN Air Director
2G	7980		Full Face Plug
4	6880		Bayonet Cap
5	6895	07145	Inhalation Gasket
6	6893	07144	Inhalation Valve
7	6898	37006	Lens Assembly
8	6894	37004	Nose Cup Assembly
9	6899	37007	Frame Assembly w/ Screws
10	6897	37005	Head Harness Assembly
**** AAD part numbers are catalog numbers only. NIOSH approved as PSD part numbers			